

Wall Faced Toilet Installation Instructions

Congratulations on purchasing this Watermark and WELS Certified, High-Quality Toilet.

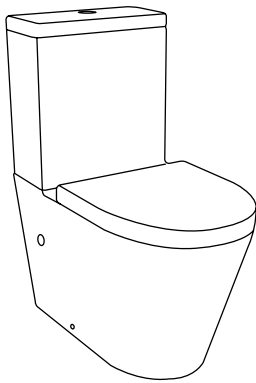

PRESSURE AND STANDARDS REQUIREMENTS

1. Inlet pressure range 100 - 500kpa
2. AS/NZS3500 requires that all water inlets within a house must be limited to 500kpa
3. Toilets must be installed by qualified trades people to the applicable standards
4. STANDARDS REFERENCES AS/NZS3500, AS/NZS1172, AS6400

To the Installing Plumber:

Please leave this instruction booklet for the customer.

DO NOT USE Concrete, Sand and Cement Mix or any other similar product when installing the Pan, doing so will void product warranty.

Prior to Installation

(Visual Inspection) & Installation requirements:

1. When the product has been unpackaged from packaging, please inspect the product to ensure it is in good order and condition and that all parts required for correct installation have been supplied. Any product that is faulty or has parts missing is to be returned to the store of purchase.
2. Sanitary ware products must be installed by a licensed plumber in accordance with the relevant installation instructions and all Australian Standards and local authority requirements. Failure to follow the relevant installation instructions, Australian Standards and local authority requirements will void the warranty and all-associated costs will be transferred to the end user.

FAILURE TO COMPLY WITH ANY OF THE ABOVE INSTRUCTIONS WILL VOID ALL WARRANTIES

Contents

Wall Faced Pan Installation	3-5
Wall Faced Cistern Installation	6
Water Supply Connection	7
Toilet Seat Installation	8
Trouble Shooting, Operation and Maintenance	9
Product Warranty	10

Wall Faced Toilet Installation Instructions

Wall Faced Pan Installation

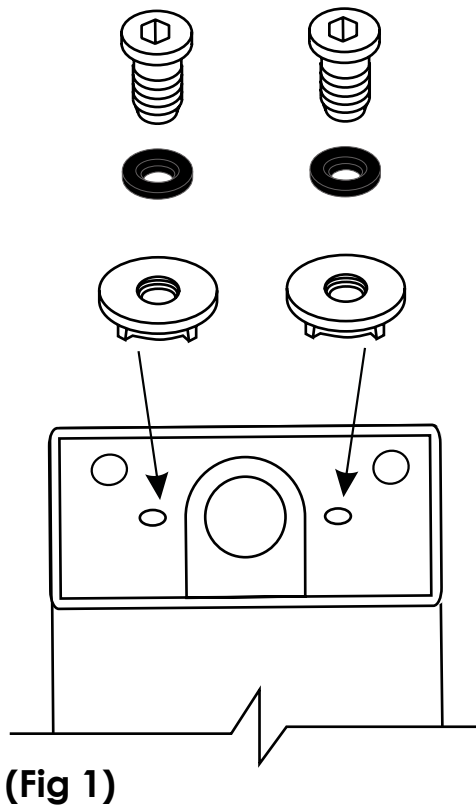

Remove the pan from the box and assemble the plastic cistern fixing lugs into the pan cistern fixing holes, with the nuts on the underside of the platform. **(Fig 1)**

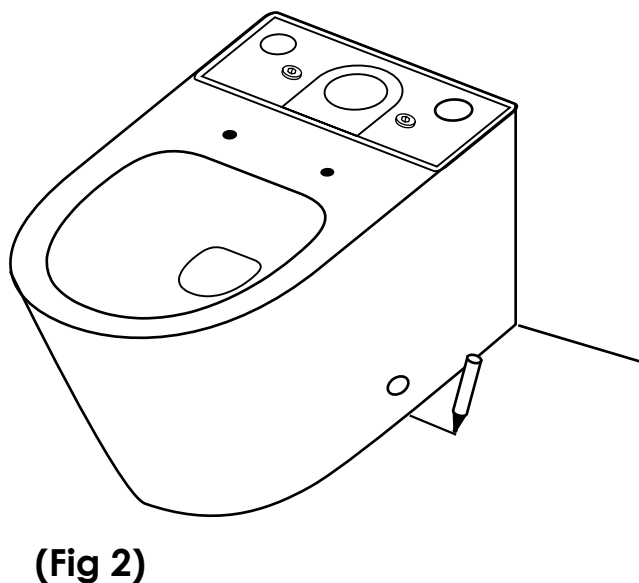

Place the pan in line with the centerline of the waste outlet and mark the bracket hole centre line on the floor. Remove the pan and drill and fix the brackets to the floor. **(Fig 2)**

Wall Faced Toilet Installation Instructions

Wall Faced Pan Installation

The set out for installation should be 180mm from finished floor to centre of outlet for "P" trap installation and between 80 and 160mm from the finished wall for "S" trap installation. An alternative connector can be obtained from store of purchase for "S" trap installation between 150 and 250mm.

NOTE: "A" is the distance from the back of the pan to the end of the outlet plus 40mm.

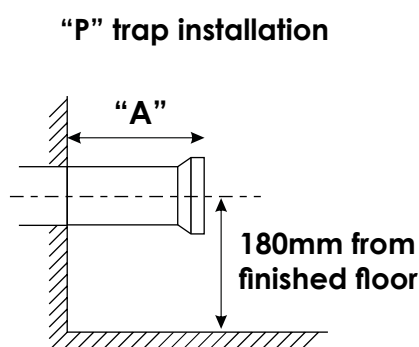
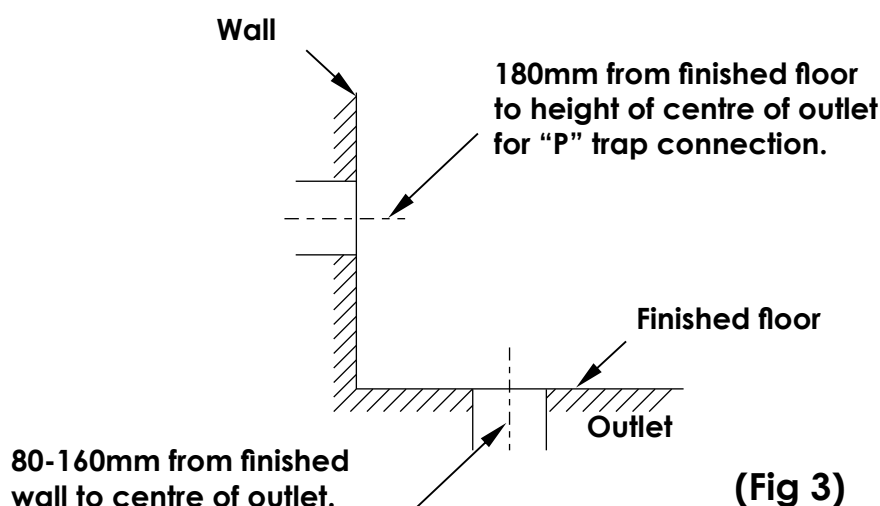

(Fig 4)

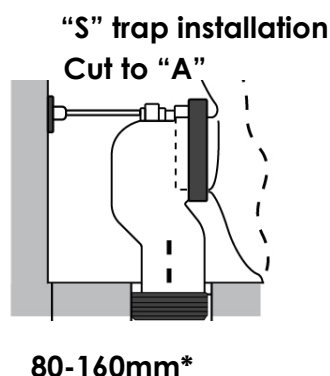

(Fig 5)

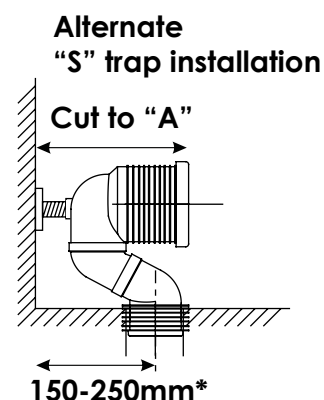

(Fig 6)

*Set Out and "S" Trap measurements will differ between all Wall Faced Toilet ranges. These measurements are intended to be used as **a guide only**. Please refer to your product specification information sheet for full product measurements.

FAILURE TO COMPLY WITH ANY OF THE ABOVE INSTRUCTIONS WILL VOID ALL WARRANTIES

Wall Faced Toilet Installation Instructions

Wall Faced Pan Installation

Fit the two plugs to both side holes. Once the appropriate pan connector has been installed, place the pan in line with the connector and push the pan back into the connector and ensure clean engagement **(Fig 7)** bucket flush to ensure no leaks.

If the floor is sloping wedge the front on the pan up to fit flush against the wall. Fit the screw plugs through the bracket holes and screw the pan to the prefit brackets and cover with caps **(Fig 8)**. Seal around and under the foot with silicone.

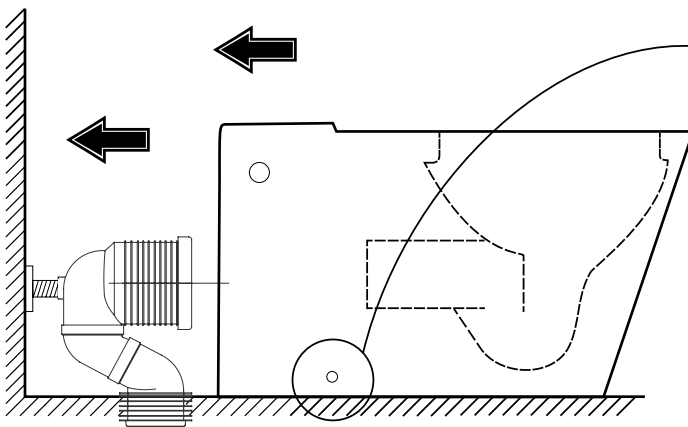

(Fig 7)

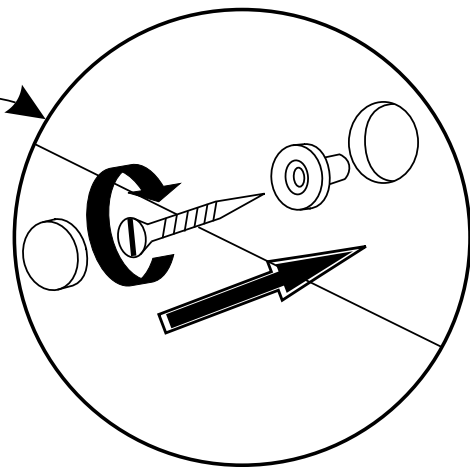

(Fig 8)

Wall Faced Toilet Installation Instructions

Cistern Installation

Place the cistern face down on top of the pan and ensure the rubber seal is positioned properly on the cistern outlet tail **(Fig 9)**.

Lift the cistern into position and lower onto the pan cistern platform **(Fig 10)**.

Locate the cistern fixing bolts through the cistern from the inside, and ensuring alignment with the pan and wall, tighten the screws **(Fig 11)**.

Connect the water supply hose to the stop cock (not supplied). Turn on the water and ensure no leaks.

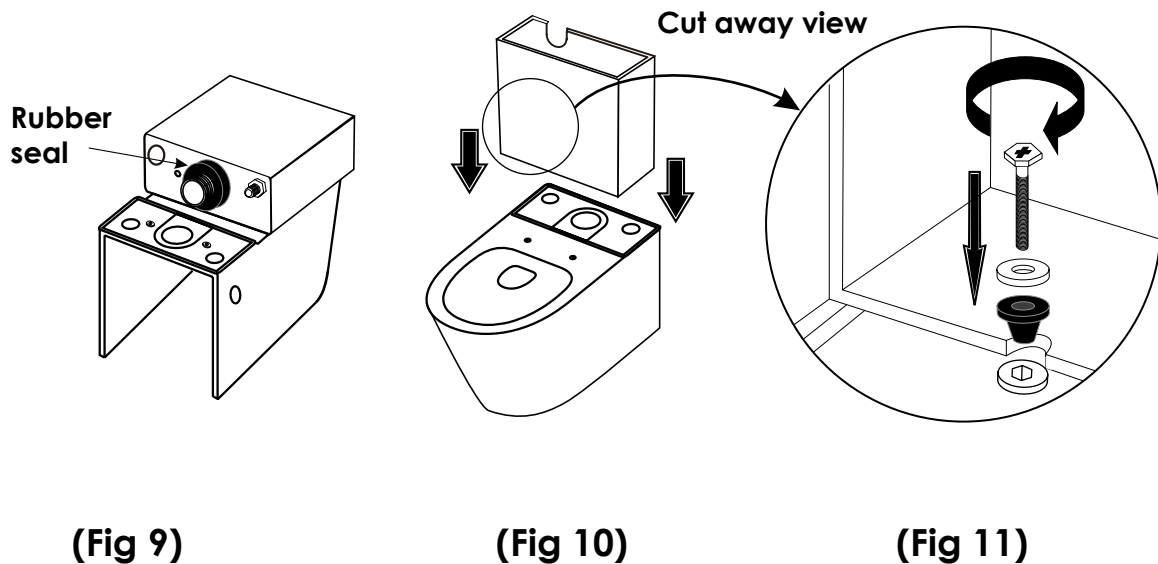

Wall Faced Toilet Installation Instructions

Water Supply Connection

Connect a stop cock (not supplied) to the nipple protruding from the wall. Connect the flexible hose from the stop cock to the inlet valve. Fill the cistern with water, flush and check for leaks. Fit the cistern lid and insert the button assembly through the lid and tighten into the outlet valve (Do Not Over Tighten). **(Fig 12)** Once the silicone under the foot is set remove the wedge and add silicon to the gap.

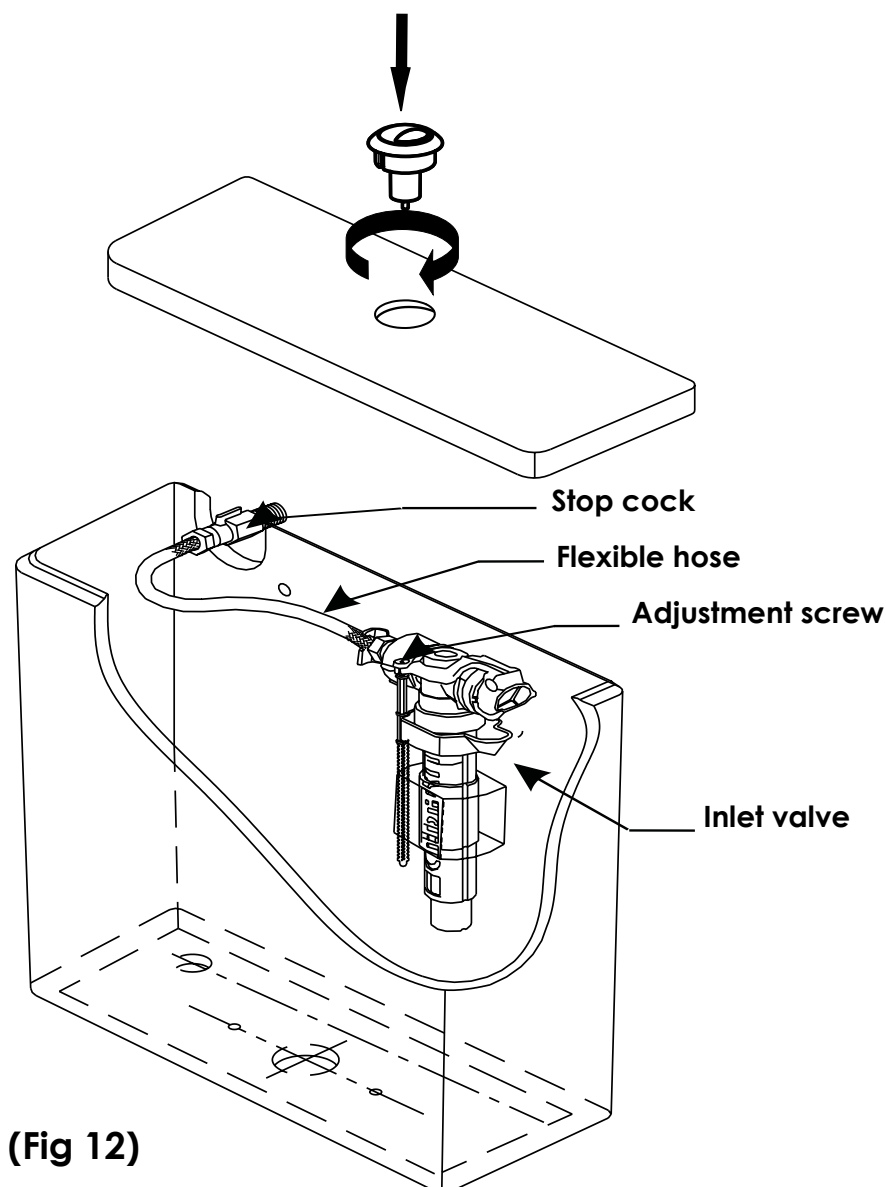

FAILURE TO COMPLY WITH ANY OF THE ABOVE INSTRUCTIONS WILL VOID ALL WARRANTIES

Wall Faced Toilet Installation Instructions

Seat Installation

Remove the seat and cover from its box. Insert the top fixing rawl plugs into the seat bold holes. Place the hinge blocks, without the stainless-steel covers, over the rawl plugs and loosely fix the screw through the hinge blocks into the rawl plugs. **(Fig 13 and 14)** Fit the seat and cover onto the hinge blocks by locating the fixing holes onto the hinge pins and push into place. Close the seat and cover onto the pan, and adjust the position in line with the rim of the pan. Tighten the screws. Open the seat and cover and depress the quick fix buttons to remove the seat and cover. Place the stainless-steel covers over the hinge blocks **(Fig 15)** and replace the seat.

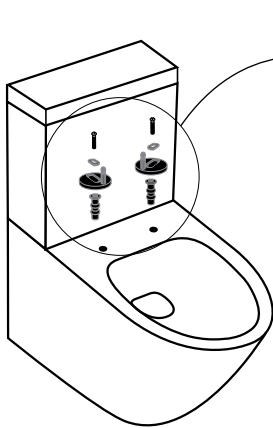

(Fig 13)

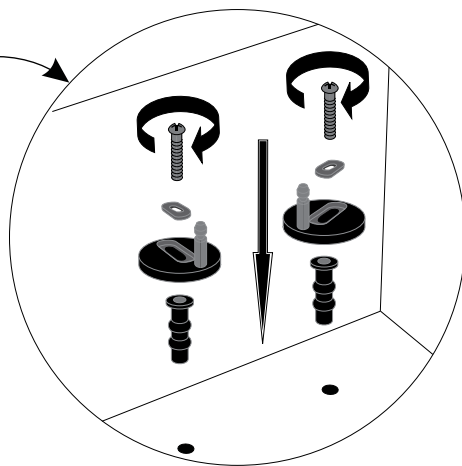

(Fig 14)

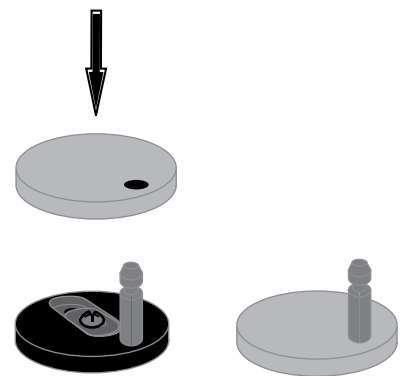

(Fig 15)

Wall Faced Toilet Installation Instructions

Trouble Shooting, Operation and Maintenance

Problem	Possible Cause	Remedy
Water is leaking into the pan.	Water level is set too high.	Re-adjust the inlet valve to lower the water level below the overflow pipe height.
	Outlet valve seal is leaking.	Remove outlet valve and clean outlet seal and seat or replace outlet seal.
Water is leaking onto the floor.	Flexible hose or connections are leaking.	Retighten connections or replace hose.
	Cistern fitting components are leaking.	Check and retighten outlet, inlet and plug nuts.
	Outlet connector broken or not engaged correctly.	Uninstall pan and check connector. Engage pan correctly, and/or replace connector.

Operation and Maintenance

- For Non-Solid Waste removal use the half flush button to conserve water.
- To clean the toilet suite only use warm soapy water, DO NOT use chemical cleaners, this will void warranty.
- Do not place chemical additives into the cistern tank as chemical additives can deteriorate the sealing rubber and valve components, this will void warranty.

FAILURE TO COMPLY WITH ANY OF THE ABOVE INSTRUCTIONS WILL VOID ALL WARRANTIES

Product Warranty

7yr replacement product or parts*

1yr labour Parts / valves / accessories / replacement parts.

****Note: Excludes valves, seats, button assembly, links, flush pipes and other internal components which carry a 1yr replacement warranty.***

For full terms and conditions including how to claim and your rights as a consumer, after sales and other enquiries, please contact your store of purchase.

In addition, if you are a consumer as defined in the Australian Consumer Law, the goods come with a guarantee that cannot be excluded and you are entitled to a replacement or refund for a major failure and compensation for any other reasonably foreseeable loss or damage. You are also entitled to have the goods repaired or replaced if the goods fail to be of acceptable quality and the failure does not amount to a major failure.