

LED Mirrors with Demister – Installation Instructions

Congratulations on the purchase of your new Casa Lusso LED MIRROR, we hope you and your family enjoy your new product and consider us for any future project. Casa Lusso products have been manufactured under the highest standards of quality and workmanship.

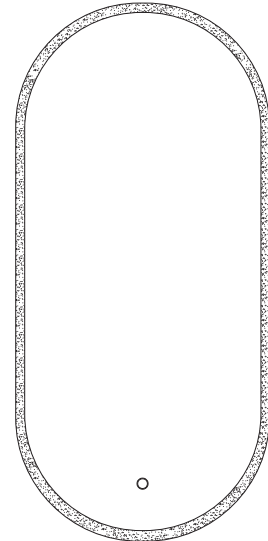
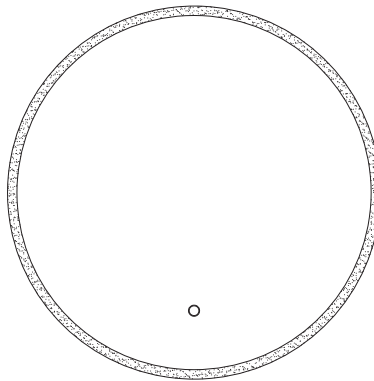
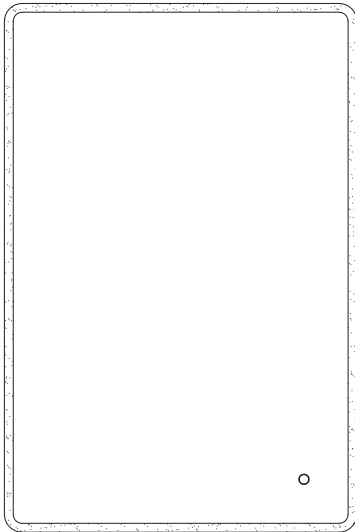

GENERAL INFORMATION

The warranty will not apply if:

- The product has been damaged by improper use;
- The product has not been used in accordance with any applicable instruction guide;
- The purchaser has attempted to modify or repair the product;
- The purchaser has failed to observe the cleaning and maintenance guidelines;
- The product is not installed by a licenced electrician.

Important:

- Mirrors are Extremely Fragile
Take Care While Transporting and Handling Mirrored Goods.
- This product should be installed by a licenced electrician.
- Ensure mains power is off before installation.
- Do not install within 600mm of direct wet area contact.
(ie. 600mm from bath or open shower)

To electrician: Please ensure a copy of the installation instructions is left with the end user for future reference.

FEATURES

Material: Copper-free Mirror With Led Lights

Installation: Wall Mount

Rating: IP44

Voltage: 220-240V

Power: 19.5W

CCT: 2700-6500K

Premium Warranty (Domestic Use) :

2 year replacement product
1 year labour

FAILURE TO COMPLY WITH ANY OF THE ABOVE INSTRUCTIONS WILL VOID ALL WARRANTIES

TOOLS REQUIRED

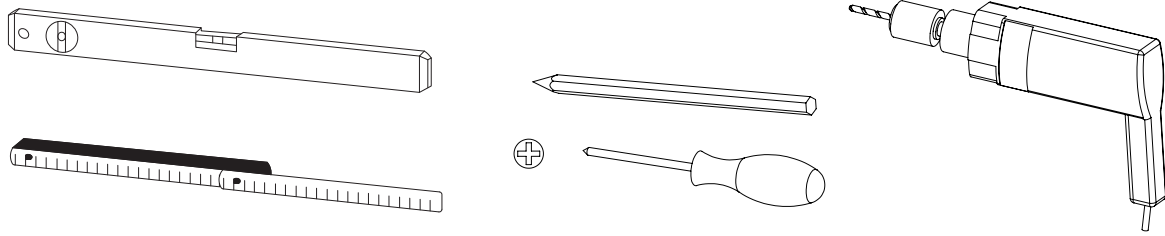

1

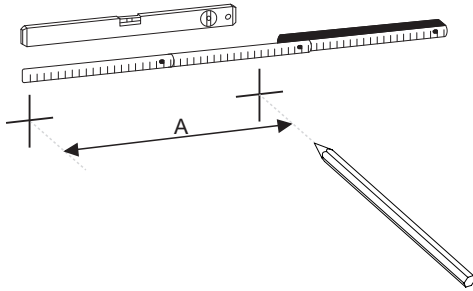

Using the hanging bracket and a spirit level mark the screw positions on the wall.

2

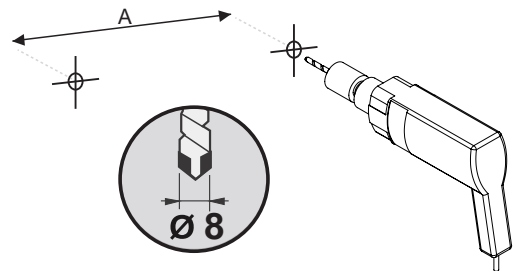

Use the drill with an appropriate drill bit to make holes at the marked places, and use a ceramic drill bit if the wall surface is made of ceramic tiles.

3

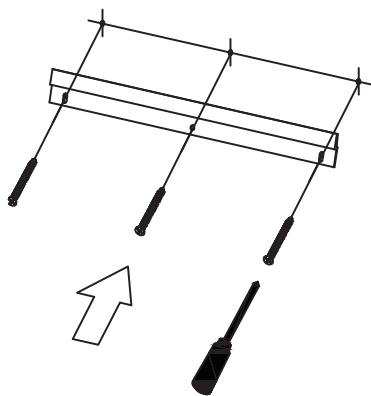

Use a screwdriver to tighten the screws securely affixing the hanging bracket to the wall.

4

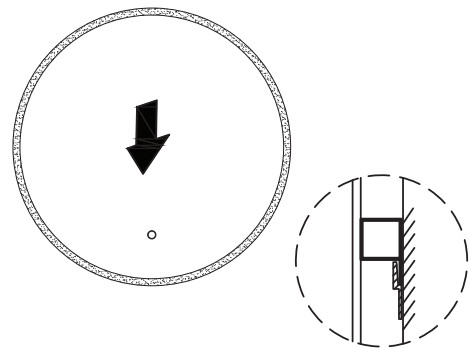

Hang the mirror on the hanging bracket. Switch on the power and test the mirror by following the user guide on the next page.

CARE INFORMATION

To keep your LED Mirror looking its best. Please ensure you follow the following care information. Clean mirror surface with a mixture of 30% isopropyl alcohol and 70% water and use a soft micro-fibre cloth or chamois. Avoid using ammonia-based or harsh chemical cleaners. Avoid getting water on the sides or the back of the mirror as damage to the silver backing can occur. In coastal areas it is recommended to wipe around the edge of the mirror once a month to avoid salt build up that can cause silver creep. Wipe off all water spillages as soon as possible using a soft micro-fibre cloth.



TURNING ON & OFF

To turn ON or OFF the LED Mirror, press your finger against the touch sensor (The demister pad will be ON when the lights are ON).

CHANGING THE LIGHT INTENSITY

Turn ON the mirror light and hold your finger on the sensor until the desired brightness is achieved.

CHANGING THE LIGHT FROM COOL TO WARM

Double tap the touch sensor to change the colour. The mirror will cycle through the colour range.

MEMORY FUNCTION

The mirror will remember your preselected colour and light intensity settings.