

EziLay Shower Tray System

The Casa Lusso Shower Tray System is made from an extruded polystyrene core. It is then layered on either side with a cement polymer mortar which has been embedded with a fibreglass mesh. These materials are 100% waterproof and perfect for wet rooms and showers.

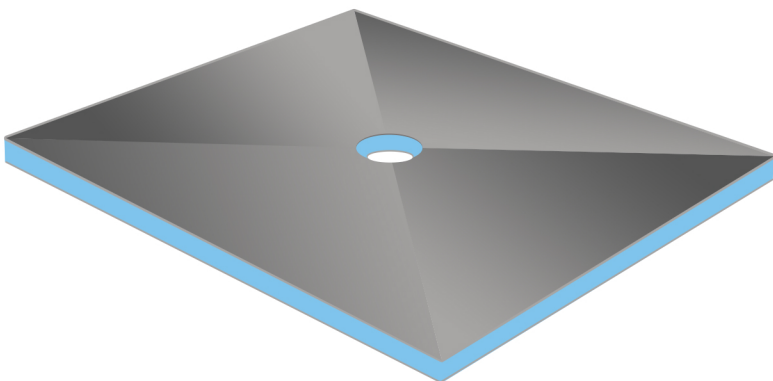

100% Waterproof boards

Acoustic & thermal Insulation

Floor Level (fixed to timber or concrete)

Pre-laid code compliant falls

Variety of sizes

Offset or central drain options

Lightweight

Can be finished with tiles

Economical

No moisture build up underneath tiles

Preformed (No skilled laying of falls)

N.B. Tiled Wet Areas Only

TIMBER FLOOR EXAMPLE

This requires cutting the floor boards for the Casa Lusso shower tray to drop into

Note: The shower tray must be fully supported

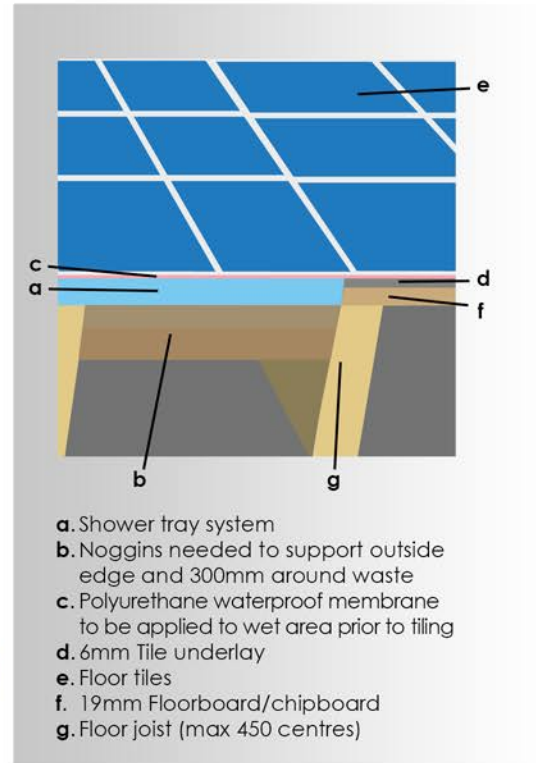
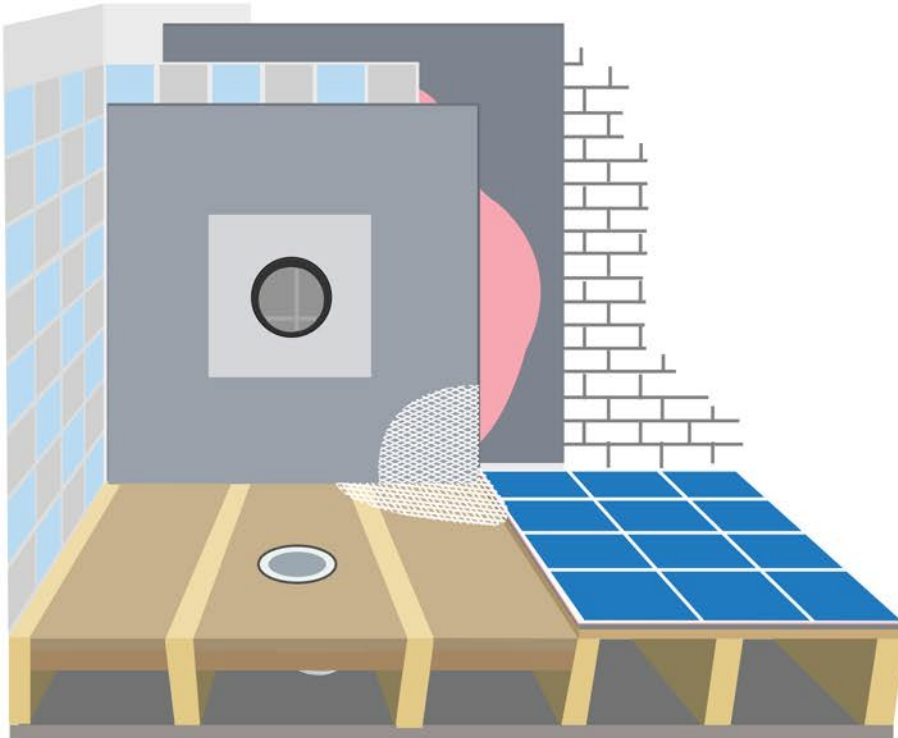

- a. Shower tray system
- b. Noggins needed to support outside edge and 300mm around waste
- c. Polyurethane waterproof membrane to be applied to wet area prior to tiling
- d. 6mm Tile underlay
- e. Floor tiles
- f. 19mm Floorboard/chipboard
- g. Floor joist (max 450 centres)

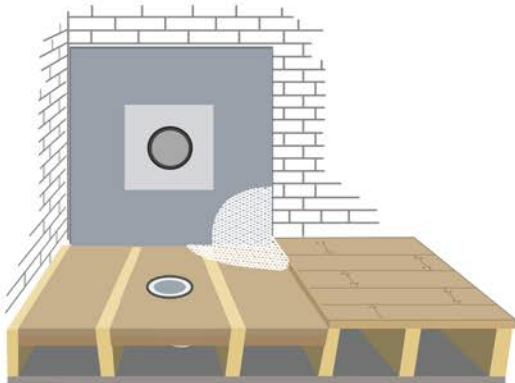

- 1 Make sure the shower tray system is fully supported. Use a polyurethane adhesive to fix directly to floor joist and noggins.

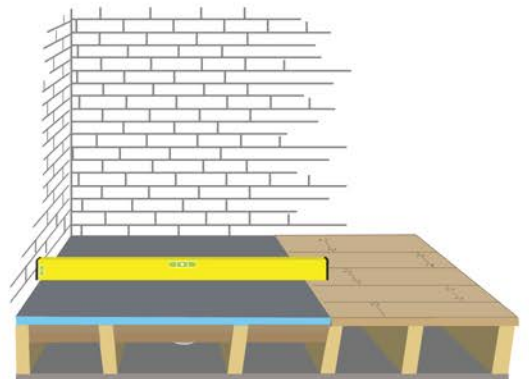

- 2 Place underlay in position, apply pressure on the underlay and check for level.

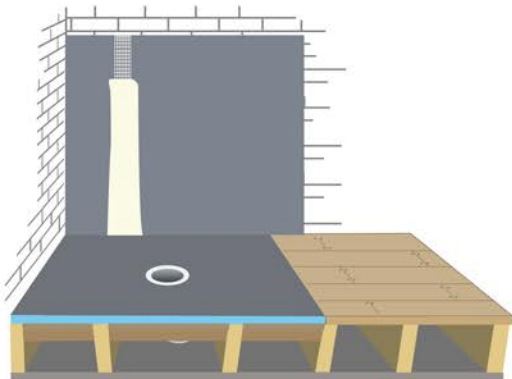

- 4 After the shower tray is in place install the wall sheeting.

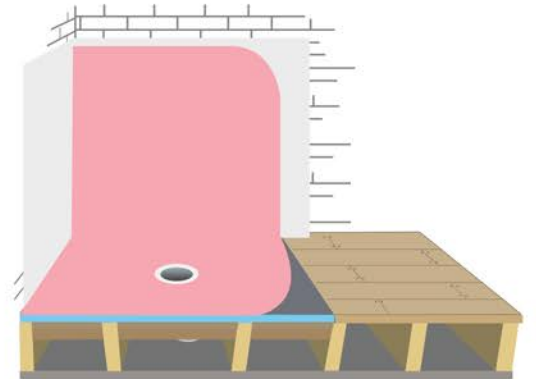

- 5 Apply an approved water proof membrane to the entire surface of the underlay, flange, water stop, and the wall sheeting according to the manufacturer recommendations.

CONCRETE FLOOR EXAMPLE

This option is perfect for applying the shower tray with concrete slabs.

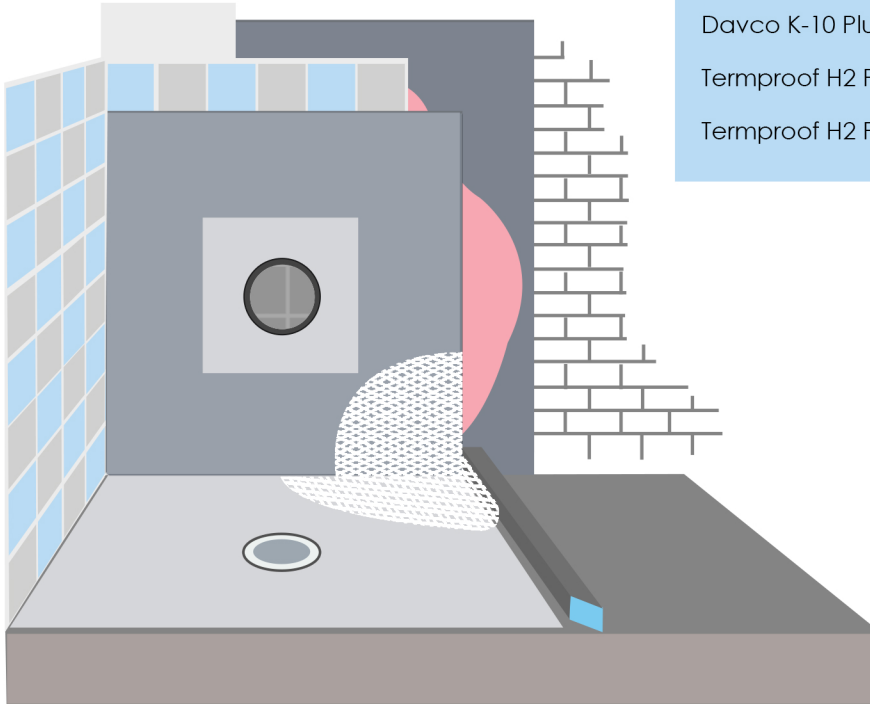

ADVISED WATERPROOFING PRODUCTS

Products advised for use in Membrane:

Davco K-10 Plus

must be used with

Termproof H2 Plus

must be used with

Termproof H2 Plus

must be used with

Primer to be used with Membrane product:

Davco Ultraprime

Termproof 200EC

Temprime on Porous

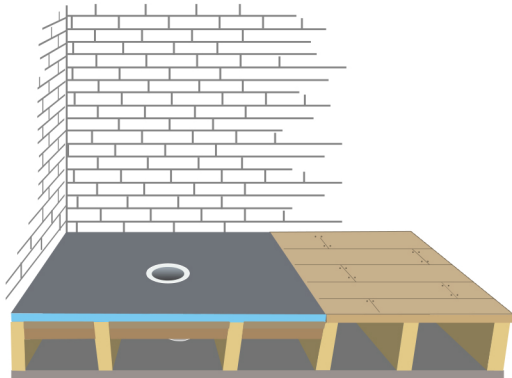

- 3** Apply a bead of polyurethane on the acrylic ring around the waste opening, plumber's glue to the waste pipe and attach puddle flange. Apply a bead of polyurethane around the outside edge of the flange.

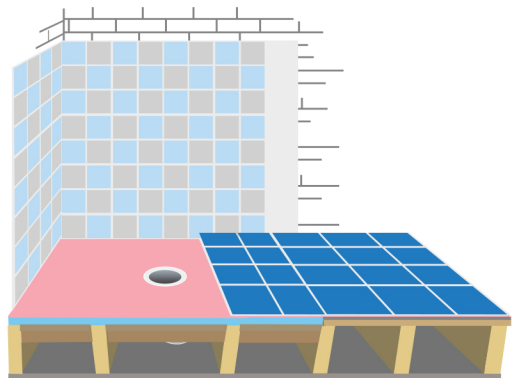

- 6** After the waterproof dries the shower can be tiled accordingly.

CENTER DRAIN SIZES

Standard thickness: 25mm

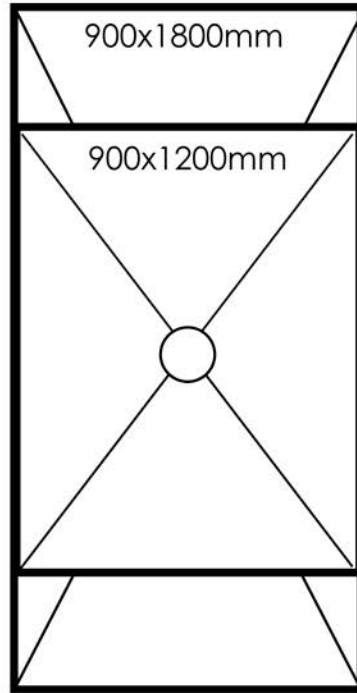
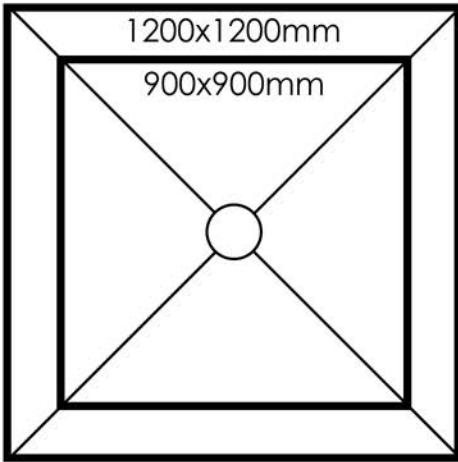

OFFSET DRAIN SIZES

Standard thickness: 25mm

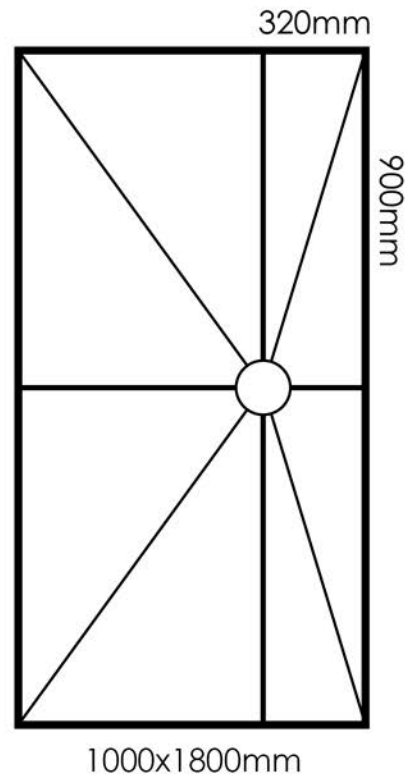
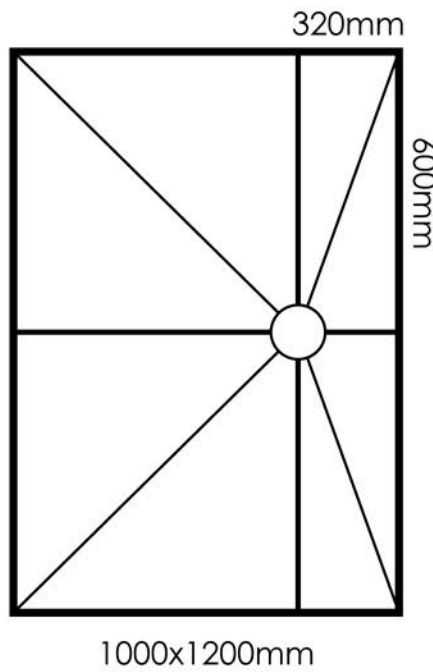
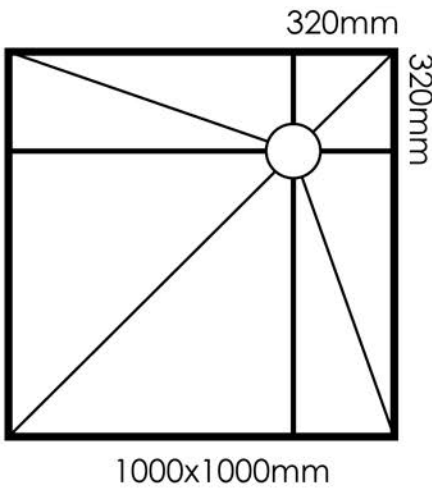

Due to our policy of continuous development, all designs and measurements are intended only as a guide and are subject to change without notice. Being hand made products they are subject to a size variance E&OE. This brochure is representative of the actual products at time of printing. Please confirm all particulars before purchase. Casa Lusso recommends having the product on site before commencing rough in.